



Titan Industries has designed and patented quality additive injection systems for over 20 years. The Titan SafTPac® and the Titan SafTCal® are the safest injectors ever made. Titan's newest products are both easy to operate and very safe for the user.

The Titan SafTPac® is a new safe touch injector designed with safety in mind by Titan Industries. It has a built-in calibration feature that allows the operator to calibrate the injector without having to touch the liquid additive or breathe any additive vapors. The calibrated cylinder displays an accurate measurement of chemical additive. With the Titan SafTPac®, there is no loss of additive because all of the liquid is in a closed loop, which eliminates spills or exposure when properly installed. The spring-loaded cylinder returns the additive to either the additive tank during operation of the additive system or additive line when the return ball valve is opened.

Both the Titan SafTPac® and the Titan SafTCal® can eliminate exposure to harmful vapors and additive liquids by the user during calibration. The standard Titan SafTPac® comes with a 100 mL cylinder with an optional 350 mL cylinder available.



Specifications

- 304 Stainless Steel machined calibration block
- 3/8" NPT inlet and outlet connections
- Designed for use with PLC's, Electronic presets, TAS systems or smart injectors
- Available unmounted as a bare block or pre-mounted on a rack
- Dimensions: 9.75"L x 3"W x 5.9"H
- Flow Sensor: 5 to 24 VDC
- Weight: 10 lbs
- Max Operating Pressure: 700 PSI for 100cc/350cc
- Inlet/Outlet: 3/8"
- Flow Rate: Up to 2.5 gal/min
- Solenoid Voltages: 110 VAC/220 VAC
- Typical K-factor: 2600 pulses/gallon

Optional Accessories

- Calibration cylinder available in 100cc and 350cc configurations as well as cylinder delete.
- Thermal Relief Bypass Kit
- Dual Pulse Output Sensor

ITEM	REQD.	P/N	DESCRIPTION
1	1	INJ-3180	INJECTOR BLOCK, 100 c/c
2	1	INJ-3181	INJECTOR BLOCK, 350 c/c
3	2	MTR-5101	OVAL GEAR SS-316
4	2	INJ-TI-MONO-10	DOWELL PINS
5	1	INJ-TI-MONO-27	MOUNTING RING (RED)
6	1	INJ-TI-MONO-28	MONOBLOCK 3190 SENSOR (RED)
7	8	INJ-TI-MONO-08	SCREW SS-316
8	1	INJ-TI-MONO-25	METER COVER FOR SENSOR
9	1	INJ-TI-MONO-04	TEFLON O RING
10	4	N/A	SENSOR MOUNTING SCREWS
11	1	INJ-TI-MONO-11	ASCO VALVE ASSEMBLY
12	1		ASCO REBUILD KIT
13	1	INJ-TI-MONO-13	CAP, LARGE
14	1	INJ-TI-MONO-14	TEFLON O RING
15	1	INJ-TI-MONO-15	STRAINER
16	1	INJ-3188	CALIBRATION CYLINDER, 100
17	1	INJ-3181	CALIBRATION CYLINDER, 350
18	1		3 WAY NEEDLE VALVE
19	1		2 WAY NEEDLE VALVE
20	1		TEFLON O RING
21	1		NEEDLE VALVE
22	2		TEFLON O RING
23	1		RETURN OUTLET RETAINER
24	1		OUTLET CHK. VALVE\ RETAINER

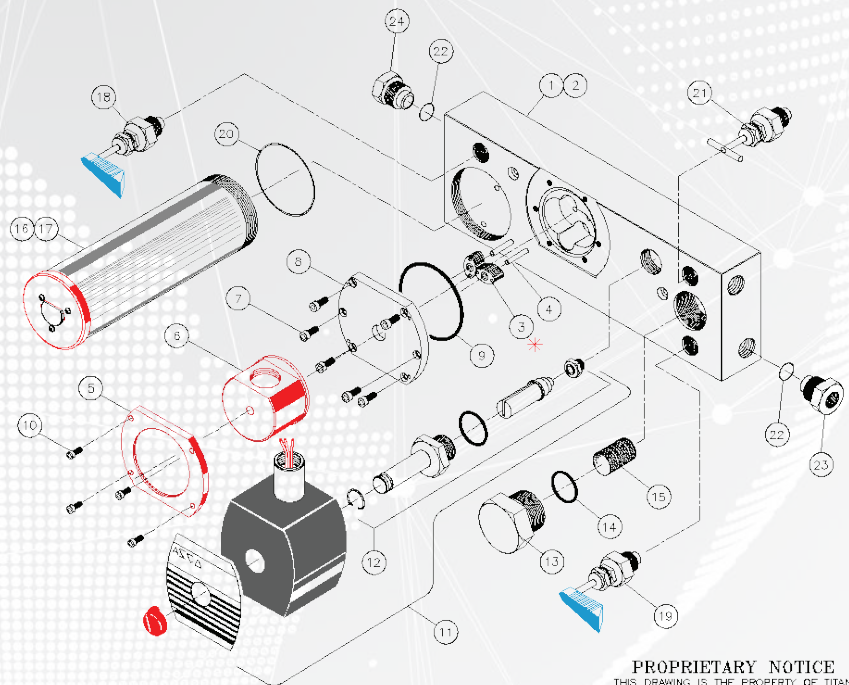

PROPRIETARY NOTICE
 THIS DRAWING IS THE PROPERTY OF TITAN INDUSTRIES INC. IS CONFIDENTIAL AND MUST NOT BE MADE PUBLIC OR COPIED WITHOUT PRIOR WRITTEN PERMISSION AND IS SUBJECT TO RETURN ON DEMAND. ALL RIGHTS OF INVENTION OR DESIGN ARE RESERVED.

